

3D Adjustable Concealed Hinge
MODEL NO. KCH80100

1. For indoor use only, not suitable for areas where it can be

- direct contact with water.
- Please check with manufacturer in advanced if use with a door closer in order to make sure correct use.
- The door is possible could not close if the door is deformed.
- Need to check the screw at regular time to make sure it is fixed.

COMPONENT PARTS

- *Installation Manual 1 pc

Vertical	±3mm
Horizontal	+4mm,-2mm
Depth	±1mm

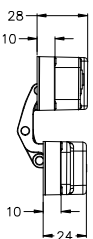

NOTE: The edge of door and frame need to be applied with C1 or R1 processing.(refer to "A" in the drawing)

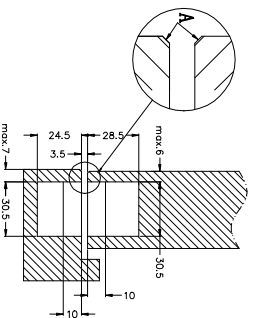

**cut out drawing for
frame side**

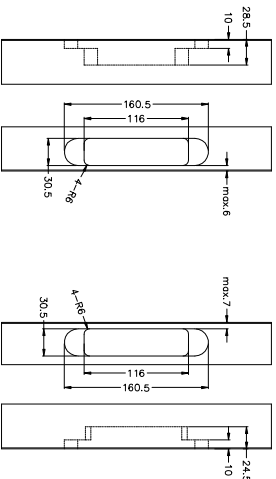
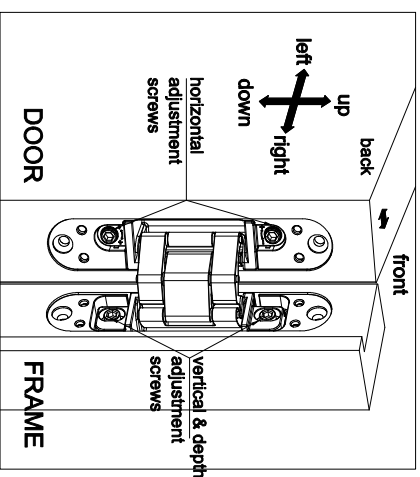

Diagram illustrating the correct installation of the door hinge. The hinge is mounted on the door and the frame, with arrows indicating the door's swing direction.

(direction shows when door is in closing situation)



1. Refer to figure a, remove the covers from hinge.
2. Install door side parts into door cutout position.
3. Refer to figure b, temporarily hang the door by inserting both upper and lower frame parts into the frame cutout position at the same time.
4. Make sure all screws are fixed after installation.

1. Make sure the hinge body is installed in correct position on door and frame.
2. Do not open/close with excessive force, or door may fall down.

1. Vertical adjustment
Loosen vertical & depth adjustment screw one turn with allen key to adjust. Then tighten screws once the door in proper height.

2. Depth adjustment
Loosen vertical & depth adjustment screw one turn with allen wrench to adjust. Then tighten screws once the door in proper position.

1. Recommended fastening force for vertical and depth adjustment is 3N.m(30.8kgf.cm).
2. To prevent door falling, do not remove vertical adjustment screws.

Turn the horizontal adjustment screw in clockwise direction to widen the gap between door and frame. To narrow the gap, turn the screw in counter clockwise direction.

1. Gently turn horizontal adjustment screws for upper and lower hinge at the same time, do not force turning of screws.
2. Do not loosen the horizontal adjustment screws in clockwise direction over than 3mm, or door may fall.

NOTE:
1. Do not handle the covers with excessive force or they may break.

Selection Chart

KCH80100	DW (mm)					Max. Door Weight (kg)
	900	950	1000	1050	1100	
DH (mm)	2100	2	3	3	3	80
	2200	3	4	4	4	
	2400	3	4	4	4	
	2600	3	4	4	4	
	2800	4	4	4	4	
	3000	4	4	4	4	

Number of hinges

KCH80100	DW (mm)					Max. Door Weight (kg)
	900	950	1000	1050	1100	
DH (mm)	2100	3	4	4	4	90
	2200	3	4	4	4	
	2400	3	4	4	4	
	2600	3	4	4	4	
	2800	4	4	4	4	
	3000	4	4	4	4	

Number of hinges

Installation Position

Normal Door

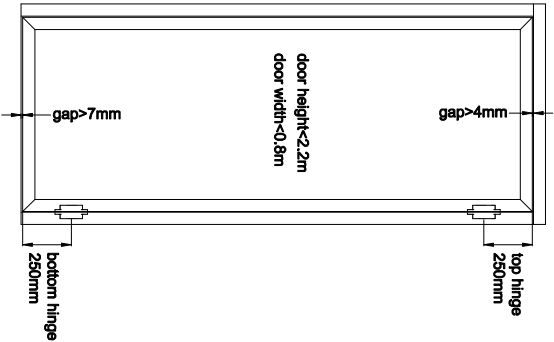

Over-width Door

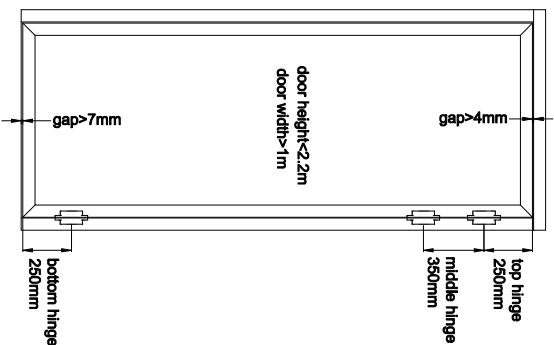

Over-height Door

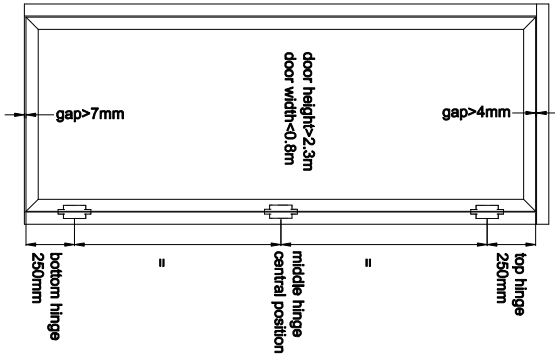

Over-height & width Door

